

# ***TAIPAN***

***EVO***

PRECISION CRAFTED, PERFORMANCE DRIVEN

**[www.scsa-au.com](http://www.scsa-au.com)**



**SOUTHERN CROSS SMALL ARMS**

## CONTENTS

INTRODUCTION .....	3
SAFETY FIRST, IT IS YOUR RESPONSIBILITY .....	4
PUMP ACTION/ STRAIGHT PULL RIFLE MODEL .....	5
SAFETY .....	6
GENERAL INFORMATION .....	7
LOADING THE FIREARM .....	13
UNLOADING THE FIREARM .....	13
DISASSEMBLY .....	14
CLEANING .....	15
CLEANING SOLVENTS AND LUBRICANTS .....	16
RIFLE MAINTENANCE .....	16
ADJUSTMENTS .....	18
UPPER RECEIVER ASSEMBLY .....	19
LOWER RECEIVER ASSEMBLY .....	20
FOREND ASSEMBLY .....	21
SAFE STORAGE .....	22
LONG TERM STORAGE .....	22
PRODUCT SERVICE .....	22
WARRANTY INFORMATION .....	23
DISCLAIMER .....	23

## INTRODUCTION

### LIMITED 5 YEAR WARRANTY

SOUTHERN CROSS SMALL ARMS (SCSA) agree to correct any defect in the firearm for the original purchaser by repair, adjustment, or replacement, at SCSA's sole option, with the same or comparable quality components (or by replacing the firearm at SCSA's option). Refer to PG 22 for more information.

### OUR GUARANTEE

SOUTHERN CROSS SMALL ARMS delivers a firearm free of defects. Our guarantee requires that firearm owners safely handle, properly break-in and properly maintain the firearm. Improper use or owner modifications to the firearm voids the guarantee and warranty.

**WARNING:** READ THIS MANUAL COMPLETELY AS YOU INSPECT YOUR NEW SOUTHERN CROSS SMALL ARMS FIREARM. MAKE SURE YOU UNDERSTAND HOW TO ASSEMBLE, OPERATE, DISASSEMBLE, MAINTAIN AND STORE YOUR FIREARM SAFELY BEFORE YOU USE IT.

## SAFETY FIRST, IT IS YOUR RESPONSIBILITY

- Treat every gun as if it **IS ALWAYS A LOADED GUN** and always keep the muzzle pointed in a safe direction.
- Never point your firearm at anything that you do not intend to shoot.
- Keep your finger off the trigger and out of the trigger guard until you are aiming at your target and ready to shoot.
- Always keep and carry your firearm with an empty chamber until you intend to shoot.
- Firearms should be unloaded when not in use.
- Be sure of your target and backstop before you shoot. Analyse what your bullet will hit if it misses or goes through the target.
- Never shoot at hard, flat surfaces or water. Bullets CAN ricochet.
- Always wear hearing and eye protection when shooting.
- Discharging firearms in poorly ventilated areas, cleaning firearms or handling ammunition may result in exposure to lead, a Substance known to be associated with birth defects, reproductive harm, and other serious injuries. Make sure you always have adequate ventilation. Wash hands after handling firearms or ammunition.
- Make sure your barrel is clear of all obstructions including (but not limited to) excessive oil, grease, cleaning patches, debris, etc. before shooting.
- Use only clean, high-quality factory loaded ammunition in good condition. SOUTHERN CROSS SMALL ARMS do not encourage the use of hand-loaded ammunition; any such use voids the SOUTHERN CROSS SMALL ARMS warranty.
- **DO NOT ALTER OR MODIFY YOUR FIREARM.**
- Do not try to change your firearm's trigger pull as alterations of trigger pull can affect sear engagement and can cause **ACCIDENTAL FIRING RESULTING IN SERIOUS INJURY OR DEATH.**
- Do not disassemble your firearm's trigger group. Any alteration or adjustment to the trigger group could result in **ACCIDENTAL FIRING RESULTING IN SERIOUS INJURY OR DEATH.**
- Store firearms and ammunition separately, and in a safe place out of reach of children.
- **IN CASE OF MALFUNCTION, STOP!** Review this manual to identify and resolve the problem. If you cannot resolve the problem, please contact SOUTHERN CROSS SMALL ARMS or your local firearms dealer where the rifle was purchased immediately.

## PUMP ACTION/ STRAIGHT PULL RIFLE MODEL

Congratulations on your choice of a SOUTHERN CROSS SMALL ARMS rifle. With proper care, your rifle will give you many years of dependable use.

Always store your rifle unloaded in a secure, dry place, where it will not be damaged and only authorised persons can access it.

Keep cartridges stored separately and securely.

**DISCLAIMER:** YOUR RIFLE MAY DIFFER FROM THOSE SHOWN THROUGHOUT THE MANUAL, DEPENDING ON OPTIONS AND REVISIONS.

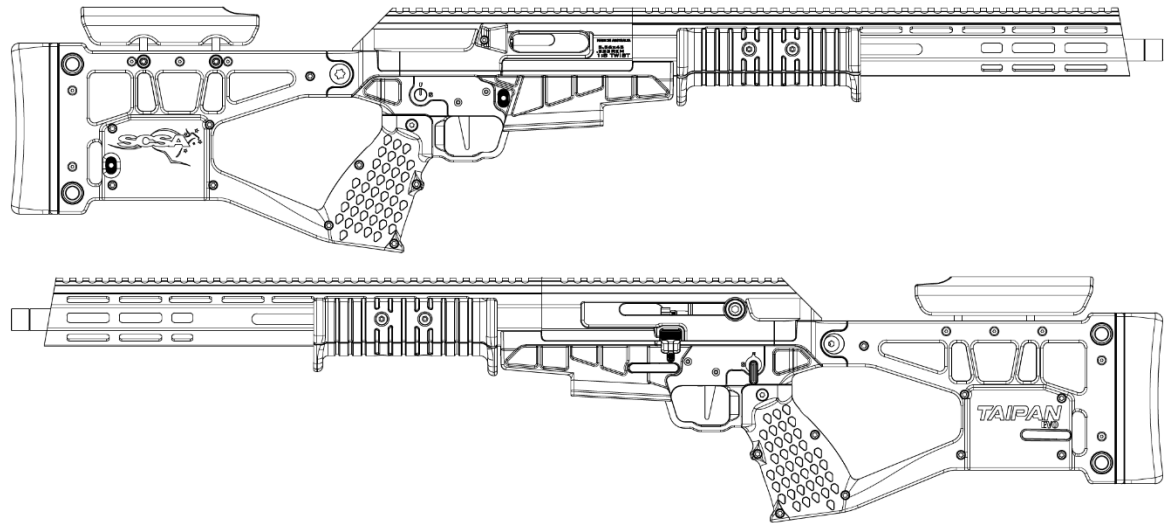

## SAFETY

Your safety lever is located on the left side of the lower receiver, operated with your thumb for right hand shooters.

The safety mechanism provides some degree of protection from accidental or unintentional discharge under normal usage when properly engaged and in good working condition.

**DO NOT RELY** on the safety mechanism exclusively for safety and accident prevention. Always follow proper rules of safety and common sense. To engage the safety, rotate the safety lever all the way anti-clockwise to the “SAFE” position.

Always keep the safety in the “SAFE” position. ONLY when you are ready to fire the rifle, rotate the safety lever to the “FIRE” position. Do not touch the trigger whilst moving the safety lever. Keep the area inside the trigger guard clear and finger off the trigger until you are ready to fire the rifle. Never pull the trigger when the safety lever is in the “SAFE” position.

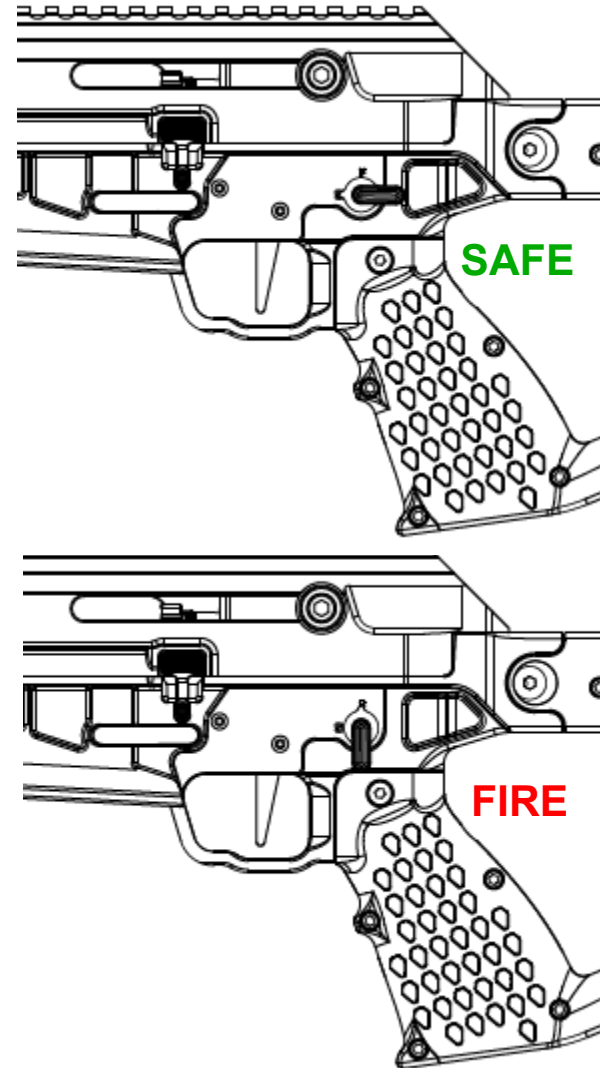

## GENERAL INFORMATION

All SOUTHERN CROSS SMALL ARMS firearms are manufactured to perform at a high degree of accuracy for purpose, reliability, and durability.

**WARNING:** YOUR SOUTHERN CROSS SMALL ARMS FIREARM WAS DESIGNED AND TESTED TO FUNCTION WITH ITS ORIGINAL COMPONENTS. ALTERATIONS TO THE FIREARM IN ANY WAY INCLUDING, BUT NOT LIMITED TO, ALTERING ORIGINAL COMPONENTS OR REPLACING PARTS WITH AFTERMARKET (NON- SOUTHERN CROSS SMALL ARMS) PARTS OR COMPONENTS CAN CAUSE MALFUNCTIONS AND WILL VOID YOUR WARRANTY. DO NOT USE SUBSTITUTE PARTS UNLESS THEY ARE MANUFACTURED OR RECOMMENDED BY SOUTHERN CROSS SMALL ARMS.

## TRIGGER SYSTEM

The trigger is factory pre-set with a pull weight of 5 to 6 pounds. SOUTHERN CROSS SMALL ARMS triggers should not be modified. Alterations of the trigger are not possible, contact SOUTHERN CROSS SMALL ARMS with concerns.

## BARREL LIFE

The SOUTHERN CROSS SMALL ARMS barrel is a high-quality stainless steel or chromoly steel specifically manufactured for the TAIPAN EVO. The profile is turned to a proprietary contour designed for a balance of accuracy and weight. Chambered to high specifications, your SOUTHERN CROSS SMALL ARMS barrel will give the accuracy performance enhancements that are desired in a high-quality pump action rifle.

## APPEARANCE

SOUTHERN CROSS SMALL ARMS rifles are all thoroughly test fired before shipping. New rifles will normally show evidence of test firing.

## AMMUNITION

1. Use only high quality, original factory manufactured ammunition. Use only ammunition of the calibre for which your firearm is chambered for. The proper calibre is permanently engraved on the barrel of your firearm and the upper receiver; never attempt to use ammunition of any other calibre.
2. The use of reloaded, "re-manufactured", hand loaded, or other nonstandard ammunition voids all warranties. Reloading is a science and improperly loaded ammunition can be extremely dangerous. Severe damage to the firearm and serious injury to the shooter or to others may result. Always use ammunition that complies with the industry performance standards established by the Sporting Arms and Ammunition Manufacturers' Institute, Inc. of the United States (SAAMI) or Permanent international Commission for the Proof of Small Arms (C.I.P.) of Belgium.
3. Firearms may be severely damaged, and serious injury to the shooter or others may result from any condition causing excessive pressure inside the chamber or barrel during firing. Excessive pressure can be caused by an obstruction in the barrel, propellant powder overloads or using incorrect or defectively assembled cartridges. In addition, the use of a dirty, corroded or damaged cartridge can lead to a burst cartridge case and consequent damage to the firearm and personal injury from the sudden escape of high-pressure propellant gas within the firearm's mechanism.
4. Immediately stop shooting and check the barrel for a possible obstruction whenever: You have difficulty in, or feel unusual resistance in chambering a cartridge, or a cartridge misfire (does not go off), or the mechanism fails to extract a fired cartridge case, or unburned grains of propellant powder is discovered spilled in the mechanism.
5. Bullets can become lodged in the barrel: If the cartridge has been improperly loaded with insufficient propellant, or if the propellant fails to ignite. (Ignition of the cartridge primer alone may push the bullet out of the cartridge case but usually does not generate sufficient energy to expel the bullet completely from the barrel), or if the bullet is not properly seated in the cartridge case. When such a cartridge is extracted from the chamber without being fired, the bullet may be left behind in the bore at the point where the rifling begins. Subsequent chambering of another cartridge may push the first bullet further into the bore.
6. If there is any reason to suspect that a bullet is obstructing the barrel, immediately unload the firearm, open the bolt and look through the bore with the aid of a torch. It is not sufficient to merely look in the chamber. A bullet may be lodged some distance down the barrel where it cannot easily be seen. If the bullet can be easily removed with a wood or brass dowel, using hand pressure only proceed. Never use a hammer on a bullet lodged. If the bullet cannot be dislodged by tapping it with a cleaning rod, take the firearm to a gunsmith.
7. Dirt, corrosion, or other foreign matter on a cartridge can impede complete chambering and may cause the cartridge case to burst upon firing. The same is true of cartridges which are damaged and/or deformed.



8. Do not oil cartridges and be sure to wipe the chamber clean of any oil preservative before commencing to shoot. Oil interferes with the friction between cartridge case and chamber wall that is necessary for safe functioning and subjects the firearm to stress like that imposed by excessive pressure. Lubricant and other foreign matter on cartridges can cause potentially dangerous ammunition malfunctions.
9. Use lubricants liberally on the moving parts of your firearm. Avoid excessive spraying of any aerosol gun care product, especially where it may get on the ammunition. All lubricants, and aerosol spray lubricants, can penetrate cartridge primers and cause misfires. Some highly penetrative lubricants can also migrate inside cartridge cases and cause deterioration of the propellant; on firing, the powder may not ignite. If only the primer ignites, there is a danger that the bullet may become lodged in the barrel.

**WARNING:** DO NOT FIRE SABOT AMMUNITION FROM YOUR RIFLE. THE SABOT COULD LODGE IN YOUR MUZZLE BRAKE CAUSING FIREARM DAMAGE AND POTENTIAL INJURY OR DEATH.

**CAUTION:** SOME TYPES / BRANDS OF AMMUNITION HAVE UNIQUE CHARACTERISTICS (E.G. EXTREMELY LIGHT OR HEAVY PROJECTILES, PARTICULARLY SOFT CARTRIDGE CASES, PROPELLANT THAT BURNS UNUSUALLY SLOWER OR MORE RAPIDLY), WHICH CAN REDUCE ITS RELIABILITY. SOUTHERN CROSS SMALL ARMS RECOMMENDS THAT YOU PURCHASE AND TEST A SMALL QUANTITY OF ANY TYPE OF AMMUNITION IN YOUR FIREARM BEFORE YOU BUY LARGE QUANTITIES.

IF YOU HAVE ANY DOUBTS ABOUT YOUR ABILITY TO HANDLE OR USE THIS FIREARM SAFELY, YOU SHOULD SEEK SUPERVISED INSTRUCTION AND TRAINING. PERSONAL INSTRUCTORS AND GUN SAFETY TRAINING COURSES ARE OFTEN AVAILABLE FROM GUN DEALERS, LAW ENFORCEMENT AGENCIES, GUN CLUBS, AND OTHER SIMILAR LOCATIONS AND GROUPS.

## ASSEMBLY

### INITIAL ASSEMBLY

Your firearm is shipped completely assembled, except the magazine.

**WARNING:** IF YOU MOUNT A SCOPE TO YOUR RIFLE, MAKE SURE THE SCOPE IS MOUNTED FAR ENOUGH FORWARD SO THAT IT WILL NOT IMPACT YOUR FACE DURING RECOIL. CHECK THE DISTANCE BETWEEN THE SCOPE AND YOUR FACE WHEN YOU ARE IN THE FIRING POSITION. KEEP IN MIND THAT YOUR EYE WILL BE CLOSER TO THE SCOPE WHEN SHOOTING FROM PRONE OR FROM THE BENCH THAN WHEN SHOOTING OFFHAND. WHEN IN DOUBT INCREASE THE EYE RELIEF.

### TRIGGER

Your trigger is set at the factory. The trigger has no adjustment; it is set for safe outdoor hunting use. The rifle can handle MODERATE impacts without firing.

**WARNING:** If you pull the trigger whilst the lower is disassembled from the upper, you can cause damage to the lower.

Any time you disassemble and reassemble a firearm, **ENSURE THAT THE RIFLE IS UNLOADED AND MAGAZINE IS REMOVED.** Then you should conduct a functional check.

### INITIAL CLEANING

Clean the bore of your firearm and lubricate the firearm as described in the Maintenance section hereafter.

SOUTHERN CROSS SMALL ARMS firearms are typically made more tightly than other pump action rifle designs. A break-in period of 50 rounds allows machined surfaces (including coated surfaces) to smooth out. Lubricate the rifle well before firing.

**WARNING:** TO ENSURE PROTECTION FROM CORROSION, YOUR SOUTHERN CROSS SMALL ARMS FIREARM HAS BEEN SHIPPED WITH PRESERVATIVE OIL IN THE ACTION. SOME OIL MAY BE IN THE CHAMBER AND THE BORE. FIRING THE FIREARM WITH PRESERVATIVE OIL IN THE BORE OR CHAMBER CAN INCREASE PRESSURES, WITH POSSIBLE FIREARM DAMAGE, PERSONAL INJURY OR DEATH. CLEAN, DRY THE BORE AND CHAMBER BEFORE FIRING YOUR SOUTHERN CROSS SMALL ARMS FIREARM.

## CHAMBERING

1. If the bolt is closed, open the bolt by pulling back on the pump grip or the bolt handle.
2. Pull pump grip/ bolt handle back to the rear most position, this will put the bolt in the correct position to strip a round from the magazine.
3. Firmly push the pump grip/ bolt handle forward to chamber the first round. The action needs to be firmly pushed forward to ensure correct chambering of the round, however the spring system is designed to assist you in this movement. This action will get the extractor to grip the case correctly for the following extraction.

**WARNING:** KEEP THE SAFETY IN THE “SAFE” POSITION UNTIL YOU ARE READY TO SHOOT.

**CAUTION:** DO NOT REST THE RIFLE ON ITS MAGAZINE WHEN YOU ARE LOADING OR FIRING IT. DOING SO CAN FORCE THE MAGAZINE UP INTO THE RIFLE, REDUCING THE RELIABILITY.

## FIRING

1. Aim at the target.
2. Set the safety selector to “FIRE”.
3. Grip the rifle firmly and squeeze the trigger increasing the pressure until the shot fires.

When firing, pay attention. If you hear a noticeable difference in sound or recoil, **STOP FIRING IMMEDIATELY**. Either situation could mean the powder in the round had an incomplete burn or the bullet is stuck in the bore. If this occurs, retract the bolt slowly and remove the fired case. Keep ejection port pointed away from your face and body. Clear the firearm and check for unburned powder in the receiver and bore. Check to see that the bullet or any other obstruction is not stuck in the bore. If there is unburned powder, clean it out before resuming operation. If a bullet or other obstruction is lodged in the bore, do not attempt to remove it. Take the rifle to a qualified gunsmith.

## BARREL BREAK-IN

Use a Boresnake pull cleaning rope

### 1. CLEAR BORE

First make sure that the barrel is clean and free of any oil or solvents from the manufacturing process. Once clear, fire 2 three-shot groups.

### 2. BORE BRUSH

Run a solvent-soaked patch through the barrel, breach to muzzle, removing it at the muzzle. Repeat this with a new soaked patch 3 times or until no black is showing on the patch. Then scrub the barrel back and forth using the calibre-correct nylon brush soaked with solvent. Ensure the brush completely exits the muzzle and chamber before reversing direction. Repeat 20 times for a total of 40 passes through the barrel. Follow this step with a dry patch until it comes out clean and dry. Clean the chamber thoroughly.

### 3. UNDERSIZED BORE BRUSH

Next, using the undersized brush, run a solvent-soaked patch through the barrel, scrubbing back and forth for a total of 20 passes through the barrel. Again, ensure the patch exits both ends of the barrel before reversing direction. You will notice a blue tint on the patches from dissolving copper residue. Repeat until no blue/copper residue is found. Follow with dry patches until they come out clean and dry.

### 4. SHOOT AGAIN

Fire another 2 three-round groups for a total of 6 rounds.

### 5. REPEAT

Repeat steps 1-4 until you have fired a total of 50 rounds. 50 rounds are usually sufficient to smooth out the surface of the barrel lining and “break in” your barrel.

## LOADING THE FIREARM

**WARNING:** ALWAYS ASSUME ALL FIREARMS ARE LOADED. ANYTIME YOU HANDLE A FIREARM, YOU SHOULD IMMEDIATELY INSPECT IT TO ASSURE THAT IT IS COMPLETELY UNLOADED.

1. Place the safety selector in the “SAFE” position.
2. Push the magazine up into the receiver until the magazine catch engages and holds the magazine.
3. Pull down on the magazine slightly to make sure it is locked into place.

**NOTE:** DO NOT slam the magazine into the lower receiver, this can cause damage to the magazine and magazine release and cause it to malfunction.

## UNLOADING THE FIREARM

1. Place safety selector in the “SAFE” position.
2. Remove the magazine by depressing the magazine release button on the right side of the lower receiver and pulling the magazine down.

**CAUTION:** THE MAGAZINE MAY FALL FREE WHEN THE MAGAZINE RELEASE BUTTON IS PRESSED. DON'T ALLOW THE MAGAZINE TO FALL ONTO A HARD SURFACE. DOING SO MAY DAMAGE THE MAGAZINE.

3. Open the bolt to extract any chambered cartridge.

**WARNING:** IF THE CARTRIDGES IN THE MAGAZINE ARE NOT REMOVED PRIOR TO THIS PROCEDURE, ANY ROUNDS LEFT IN IT WILL BE CHAMBERED, WHICH COULD LEAD TO AN UNINTENTIONAL DISCHARGE. THE RIFLE WILL FIRE WITH A ROUND CHAMBERED AND THE MAGAZINE REMOVED.

## DISASSEMBLY

The TAIPAN EVO comes completely assembled, there is NO NEED to disassemble the rifle. If there is a malfunction that can't be resolved in the assembled state then contact SOUTHERN CROSS SMALL ARMS, the firearms dealers where the rifle was purchased or your local qualified gunsmith. The disassembly of the rifle is not complicated but there is a need for sound firearms knowledge to do so safely and be able to assemble and do the correct function tests required to ensure the firearm is safe to handle upon assembly.

**WARNING:** ALWAYS UNLOAD YOUR FIREARM BEFORE CLEANING, LUBRICATION, DISASSEMBLY OR REASSEMBLY.

**WARNING:** ALWAYS WEAR SAFETY GLASSES WHEN DISASSEMBLING, MAINTAINING OR ASSEMBLING YOUR FIREARM.

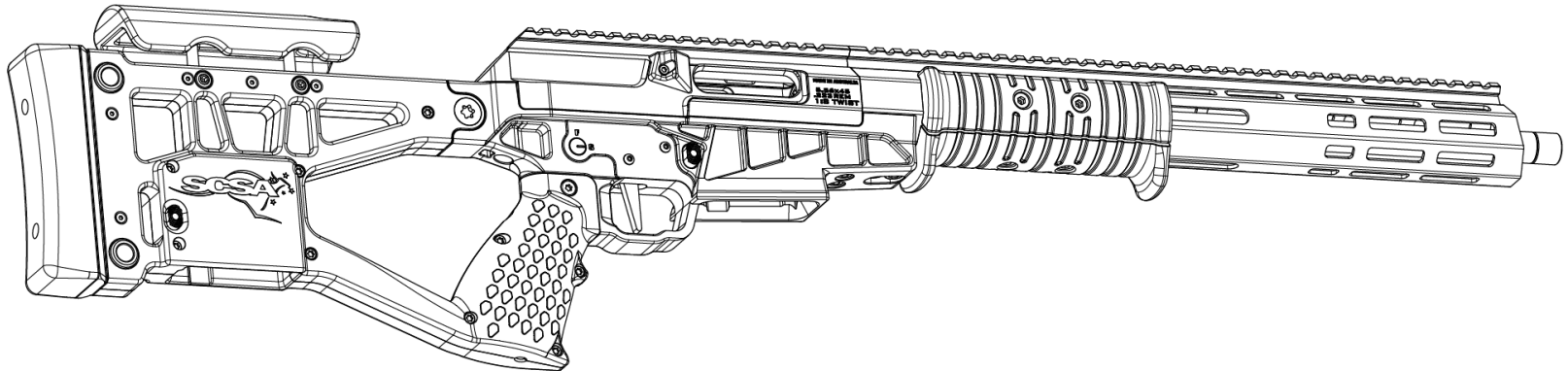

## CLEANING

### MUZZLE BRAKE RECOMMENDATIONS

1. While cleaning the rifle, if a muzzle brake is fitted it should be removed and cleaned separately.
2. Use hearing protection when discharging your rifle due to the increased volume caused by the muzzle brake and the 16.5-inch barrel. The muzzle blast is significant and permanent hearing damage may occur

Clean your rifle after use. Badly fouled barrels can shoot inaccurately and will corrode much easier than carefully cleaned ones.

1. Lock the Bolt in the open position and remove the magazine.
2. Place the rifle on its side with the ejection port facing upward or if a gun vice/stand is available, position the rifle right side up in the vice/stand.
3. Select the correct calibre cleaning brush and attach to the cleaning rod.
4. Put the cleaning brush into the gun solvent.
5. ALWAYS push the cleaning/oiling patch from the muzzle end.
6. Push the cleaning brush through the barrel several times.

The TAIPAN EVO is coated in a Cerakote finish, it is first anodised for hard wearing properties of the internal components.

The Cerakote finish will get finger marks and non-permanent stains from handling. This can be easily remedied by wiping the rifle down with a dampened rag using warm water or gun care cleaner.

**CAUTION:** DO NOT REVERSE THE DIRECTION OF THE BORE BRUSH WHILE IT IS IN THE BORE.

7. Remove the brush from the cleaning rod and attach the patch tip with a patch. It is advisable to occasionally remove copper fouling from the barrel. There are various solvents and mechanical cleaners for this purpose.
8. Repeat several times, using a clean patch each time, until the patch is not dirty.
9. Push a clean patch saturated with oil through the barrel.
10. Push a clean dry patch through the barrel to remove excess oil.

## CLEANING RECOIL PAD AND COMB HEIGHT ADJUSTMENT BAR

NOTE: RECOIL PAD/spacers and comb height adjustment can be removed Individually

1. Lock the Bolt in the open and remove the magazine.
2. Ensure the rifle is not loaded.
3. Remove RECOIL PAD/spacers and comb height set screws
4. Slide the recoil pad and cheek rest out of their housing/position from the stock.

## CLEANING SOLVENTS AND LUBRICANTS

We recommend using high quality firearm solvents to remove metal fouling from the bore. Lubricate your rifle generously with high quality firearms lubricants. Under NO condition should any lubricant containing graphite be used with your rifle. Graphite can encourage rapid corrosion in your rifle. In addition to cleaning solvents and lubricants, the basic cleaning equipment you will need includes a Boresnake rope type cleaner, cleaning rod, a bronze bore brush, chamber brushes, a toothbrush, patches, pipe cleaners and the most important item: a lint-free cloth. The chamber and bore can be occasionally flushed with an evaporative cleaner (carburettor cleaner) with the bolt open and locked and the muzzle pointing down into a solvent catch. This also help remove any carbon build up in the throat area of the chamber/lands.

## RIFLE MAINTENANCE

1. Clean stock with a dampened rag using warm water or mild firearm care cleaner.
2. Use gun oil on the barrel and wipe dry to restore the original look.
3. Install the chamber brush on the cleaning rod, dip it in cleaning solvent and insert into the chamber and locking lugs. Clean by pushing and twisting the chamber cleaning rod.
4. Take the bore brush off the rod and install a swab holder and swab. Apply cleaning solvent to the swab and then run it through the muzzle and out the chamber.
5. To remove carbon, build up, let the solvent sit then wipe clean. A nylon bore brush may be used with care to remove heavy carbon build-up.
6. Wipe the bore dry by running clean swabs all the way through from the muzzle to the chamber.
7. Inspect the barrel and stock for cracks, bends or breaks. Be sure the barrel has no obstructions.



8. Lightly lubricate the bore, chamber and outer surface of the barrel.
9. With a lubricated swab, run the rod from the muzzle to the chamber. Do not over lubricate.
10. Clean and dry the chamber of any oil or residue, always perform last.

**WARNING:** LEAD MAY BE PRESENT IN THE FOULING OF A DIRTY RIFLE. AVOID CONTACT WITH IT AND CLEAN HANDS AFTERWARD TO AVOID INGESTING LEAD.

**CAUTION:** DO NOT REVERSE THE DIRECTION OF THE BORE BRUSH WHILE IT IS IN THE BORE.

## ADJUSTMENTS

Your new TAIPAN EVO comes with an adjustable length of pull and comb height adjustments. By loosening the set screws located on the side of the stock right side of the rifle, you can adjust the length of the comb height. Using a 3 mm Allen wrench simply loosen both bolts for the desired adjustment. Slide the cheek comb to the new location and tighten the bolts. The TAIPAN EVO polymer buttstock houses a magazine release to carry a spare magazine.

### **CAUTION! DO NOT OVER TIGHTEN**

The recoil pad screws are accessed from the face of the recoil pad. Use a 4 mm Allen wrench to loosen and remove. Spacers are in 5 mm increments, install the desired amount and use the correct length screws supplied to secure the assembly in position.

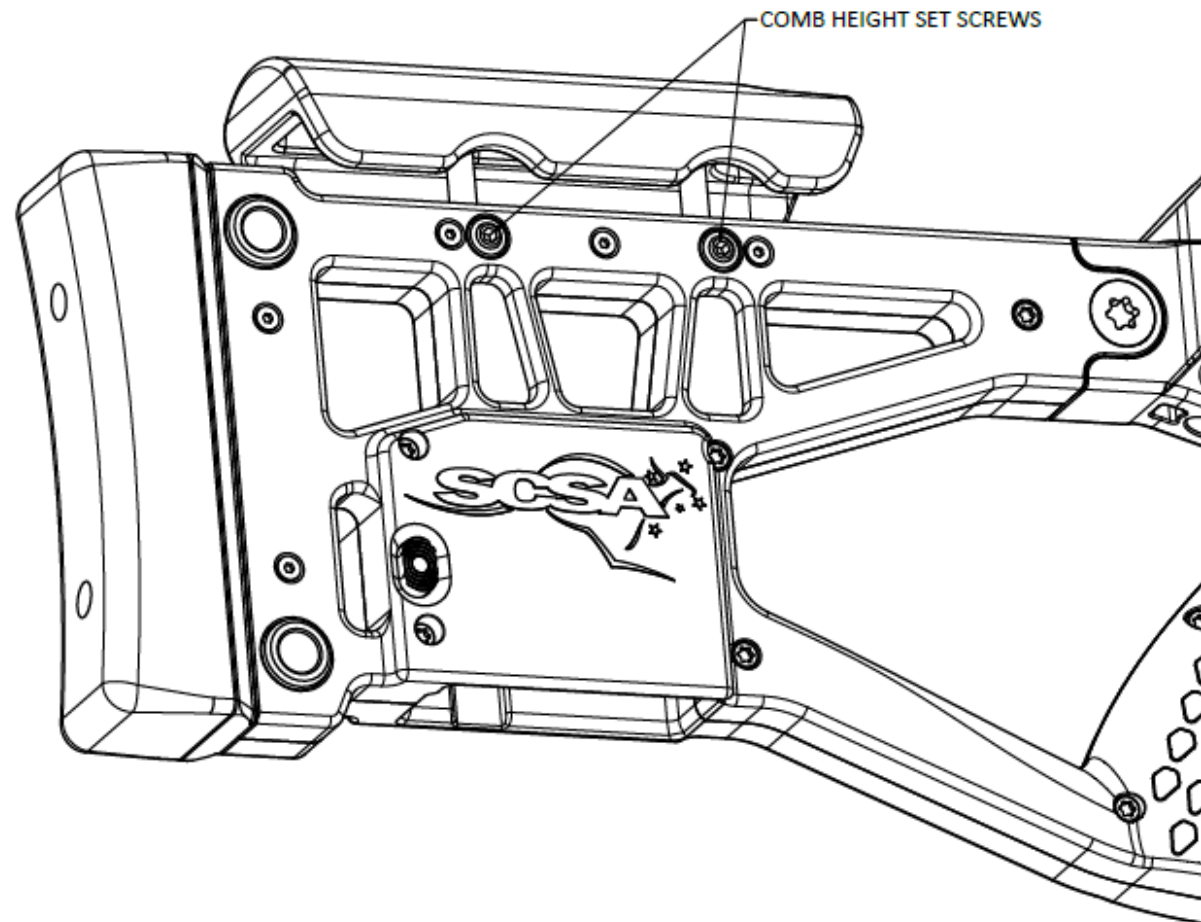

## UPPER RECEIVER ASSEMBLY

The upper receiver houses the bolt carrier group (BCG). The BCG should not need to be taken apart for cleaning. The BCG assembly simply sits in the upper receiver and is free to slide back and forth.

The BCG contains the bolt handle which allows for the straight pull operation.

The BCG group should be kept clean and lubricated on a regular basis.

The upper assembly also features a brass deflector that helps kick the spent brass away from the shooters face for both left and right-handed shooters.

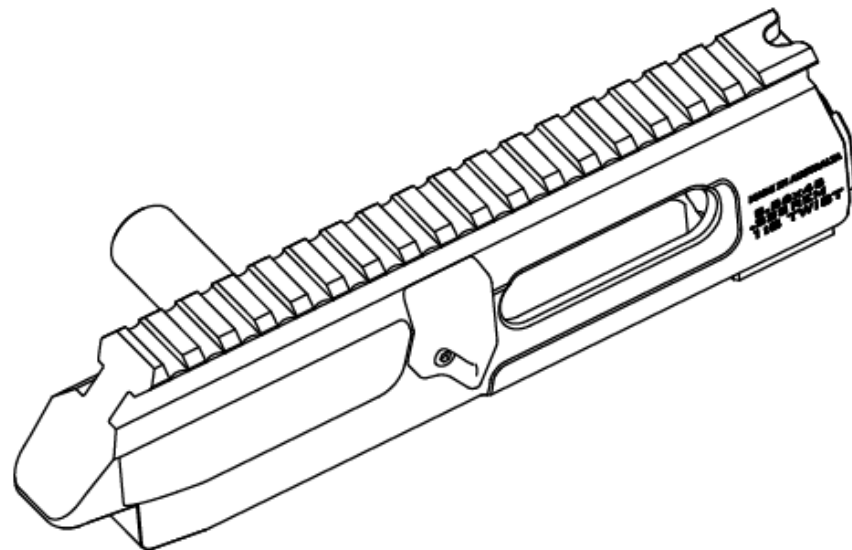
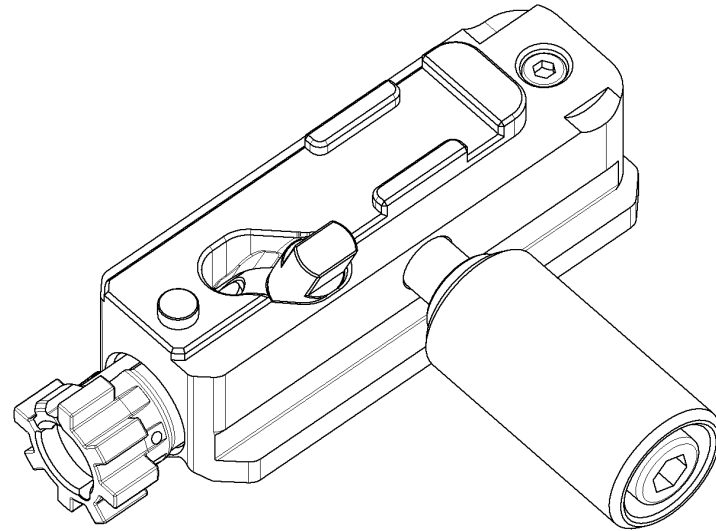

## LOWER RECEIVER ASSEMBLY

The lower receiver assembly houses the fire control group, comprised of the trigger group and the fire selector / safety lever.

Magazine release assembly and bolt carrier lock is part of the lower receiver assembly.

**WARNING:** UNDER NO CIRCUMSTANCE SHOULD THE TRIGGER GROUP BE DISASSEMBLED OR MODIFIED. ANY MODIFICATION OF THE TRIGGER GROUP COULD RENDER THE FIREARM DANGEROUS, CAUSING ACCIDENTAL DISCHARGE WHICH COULD CAUSE SERIOUS HARM OR DEATH.

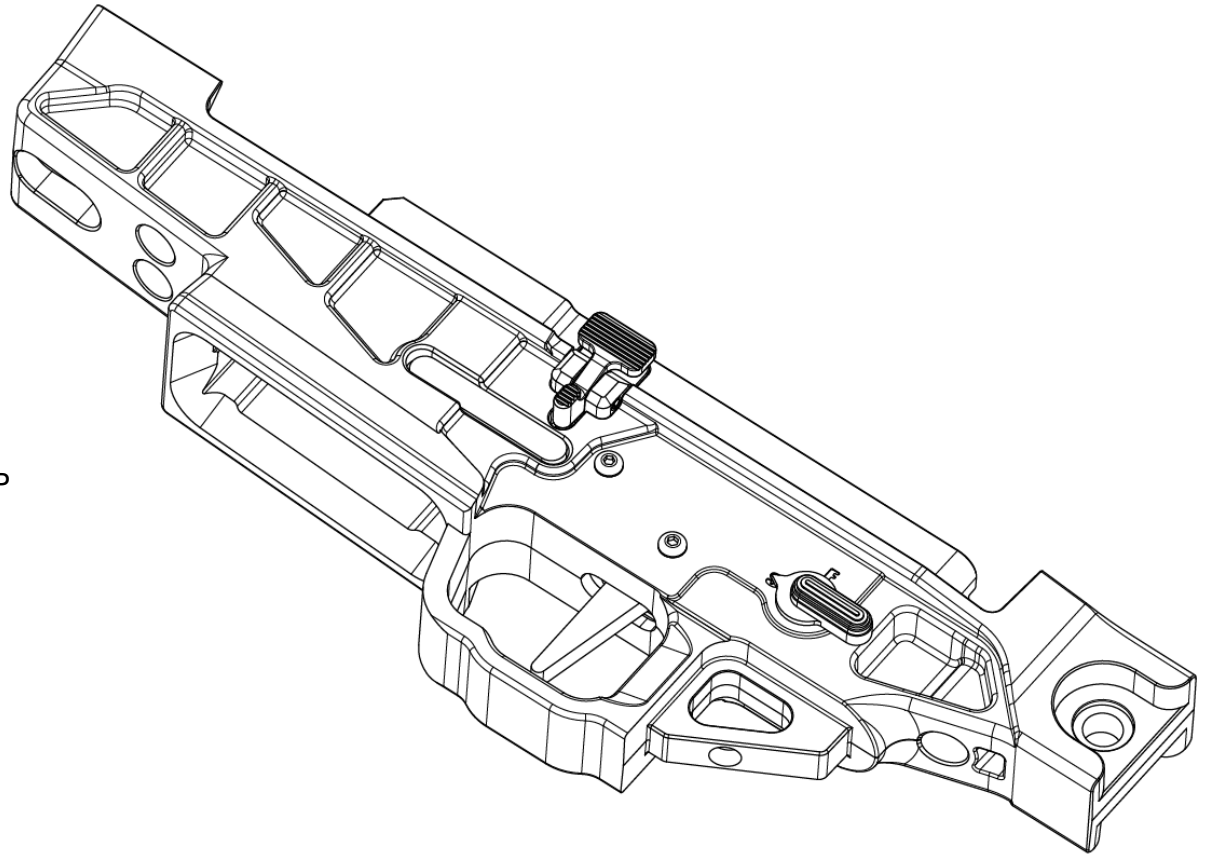

## FOREND ASSEMBLY

The forend assembly houses the plastic injection moulded grips which are fixed with six bolts that screw to the action bar and piston assembly.

The spring assembly is contained within the forend assembly which indexes off the barrel and the rear of the pump piston.

The action bar interfaces with the bolt carrier group (BCG) and it is the driving mechanism of the pump action rifle.

A full length Picatinny rail on the handguard allows for a wide variety of optics options. M-LOK slots on the sides and bottom facilitate attachments of various accessories like bipods, quick detach (QD) sling swivel cups, torch assemblies.

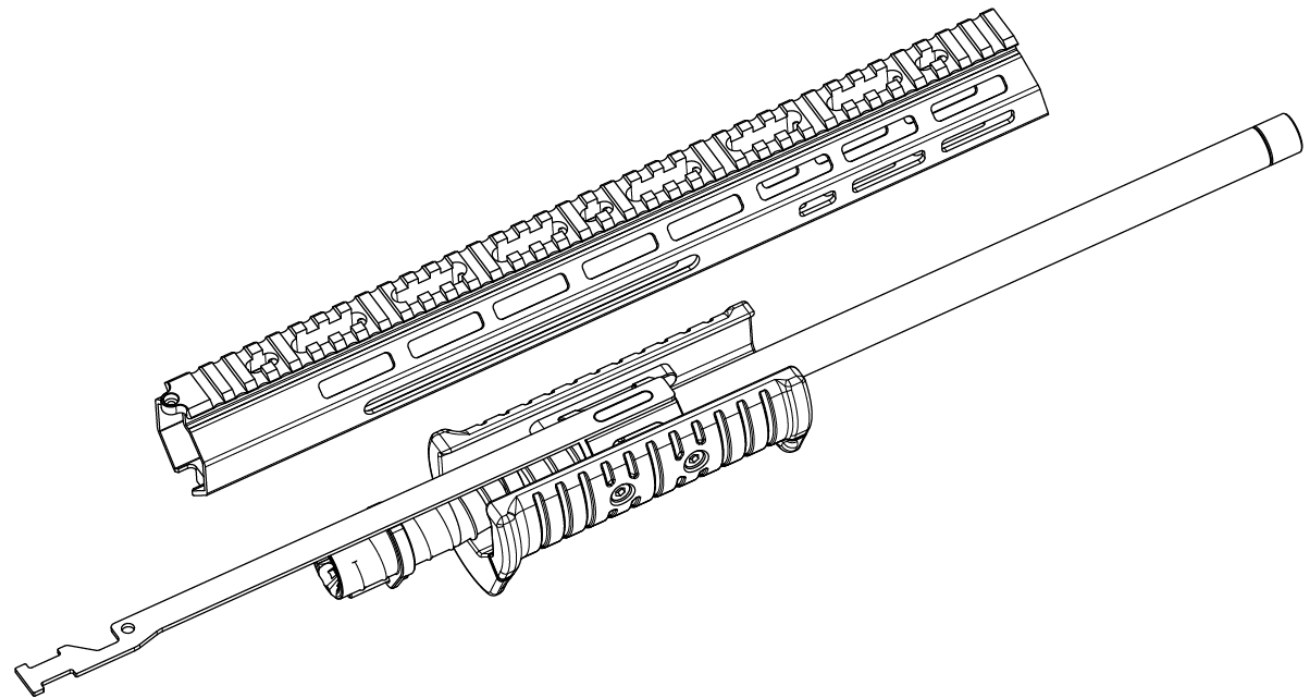

## SAFE STORAGE

Always make sure both the chamber and magazine are unloaded before placing the firearm in storage. Store your rifle in a securely locked gun safe. Store your ammunition in a separate location from the rifle. Always follow local jurisdiction regarding safe storage of firearms.

**WARNING:** ALWAYS CHECK TO MAKE SURE YOUR FIREARM IS UNLOADED. ALWAYS STORE YOUR FIREARM IN A SAFE LOCATION SEPARATE FROM THE AMMUNITION.

**WARNING:** IF YOU HAVE MORE THAN ONE SIMILAR FIREARM, MAKE SURE THAT YOU SPECIFICALLY IDENTIFY THE REMOVED ASSEMBLY WITH ITS ORIGINAL FIREARM AS THE ASSEMBLY'S MAY NOT BE INTERCHANGEABLE.

## LONG TERM STORAGE

CLEAN YOUR RIFLE WELL AND APPLY A GOOD QUALITY PRESERVATIVE.  
CLEAR ALL CARTRIDGES FROM YOUR FIREARM, REMOVE THE DETACHABLE MAGAZINE.

When you're taking your firearm out of long-term storage, remove the preservative / oil and lubricate as stated

RIFLE MAINTENANCE (PG 16).

## PRODUCT SERVICE

Thank you for choosing a SOUTHERN CROSS SMALL ARMS firearm. Years of dedication and innovation have led to the TAIPAN EVO, and we hope you'll enjoy it as much as we do. For the most complete service and after sales support contact us at.

**service@scsa-au.com**

## WARRANTY INFORMATION

SOUTHERN CROSS SMALL ARMS warrants that the enclosed firearm was originally manufactured free of defects in material, workmanship and mechanical function. For the lifetime of the product, SOUTHERN CROSS SMALL ARMS agrees to correct any defect in the firearm for the original purchaser by repair, adjustment, or replacement, at SOUTHERN CROSS SMALL ARMS' sole option, with the same or comparable quality components (or by replacing the firearms at SOUTHERN CROSS SMALL ARMS' option), subject to the limitations detailed below.

This limited 5-year warranty is null and void if the firearm has been misused; damaged (By accident or abuse); fired with improper ammunition; fired with an obstruction in the barrel; damaged through failure to provide reasonable and necessary maintenance as described in the manual accompanying the firearm, or if unauthorised repair or any alteration, including of a cosmetic nature, has been performed on the firearm by a party other than SOUTHERN CROSS SMALL ARMS.

This limited warranty does not apply to normal wear and tear of any parts. Subject to the foregoing, this limited warranty confers the right to have the covered firearm, or its parts repaired, adjusted or replaced exclusively upon the original purchaser, which right is not transferable to any other person. No implied warranties of any kind are made herein, and this warranty does not apply to any accessory items connected or attached to the firearm. In no event shall SOUTHERN CROSS SMALL ARMS be liable for any incidental or consequential damages arising from or in connection with this limited warranty.

This rifle is capable of being very accurate (based on quality factory ammunition, not all rifles shoot the same ammunition accurately). The customer is responsible to ensure proper break-in of the firearm during the warranty period, select appropriate ammunition, ensure proper lubrication and use proper conditions.

*For warranty related queries contact us on **service@scsa-au.com***

## DISCLAIMER

SOUTHERN CROSS SMALL ARMS delivers a firearm free of defects. Our guarantee requires that firearm owners safely handle, properly break in, and properly maintain the firearm. Improper use or owner modifications to the firearm voids the guarantee and warranty.